

D-CELL Mag-Lite® LED Flashlight specifications

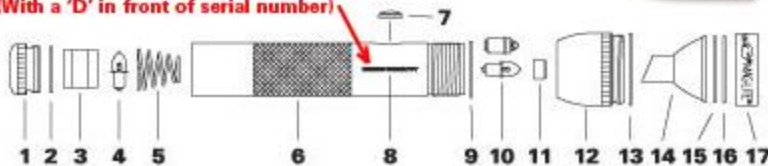

(With a 'D' in front of serial number)



- 1** Tail Cap (Part No. **201-191**)
- 2** O-ring, tail cap (Part No **108-207**)
- 3** Lamp Protector (Part No **108-037**)
- 4** Spare Lamp (**see below**)
- 5** Battery Spring (Part No **108-032**)
- 6** Barrel with switch (**see below**)
- 7** Switch Seal (Part No **108-034**)
- 8** Serial Number
- 9** O-ring, barrel (Part No. **108-206**)

- 10** Lamp/LED (**see below**)
- 11** Lamp Retainer (Part No **201-599**)
- 12** Head (**201-660**)
- 13** O-ring, Head (Part No **108-025**)
- 14** Reflector (Part No **108-036**)
- 15** Clear Lens (Part No **108-031**)
- 16** O-ring, face cap (Part No **108-026**)
- 17** Face Cap (Part No **201-157**)

NOTE: This Specification Chart Only Applies to Maglite® LED D-Cell Flashlights with a "D" in front of the serial number.

For Maglite® LED D-Cell Flashlights with a "DL" in front of the serial number. ["Click Here"](#)

Product Name	Length	Barrel Diameter	Barrel Part No.	Head Diameter	Weight With Batteries	Battery Required	White Star Lamp	Mag-num Star Lamp (Opt.)**	LED Module (Opt.) ¹
2D-Cell Mag-Lite® LED Flashlight	10"-254mm	1-9/16"-39.67mm	(see below)*	2-1/4"-57mm	23.8 oz.-674g	(2) D Size Alkaline	LWSA201	LMSA201	SH32DCW6
3D-Cell Mag-Lite® LED Flashlight	12-11/32"-313mm	1-1/4"-31.75mm	108-226	2-1/4"-57mm	30.02 oz.-856g	(3) D Size Alkaline	LWSA301	LMSA301	SH33DCW6
4D-Cell Mag-Lite® LED Flashlight	14-23/32"-313mm	1-9/16"-39.67mm	(see below)*	2-1/4"-57mm	36.8 oz.-1043g	(4) D Size Alkaline	LWSA401	LMSA401	SH34DCW6

**ANSI
DATA
Coming
Soon**

¹ Peak Beam Candlepower is approximate and may vary between flashlights, lamps, and/or batteries. Data presented is for D-Cell Mag-Lite® flashlight equipped with a White Star® lamp. * No longer available. ** Optional, Xenon upgrade lamp 1 Discontinued